

Other Product Range

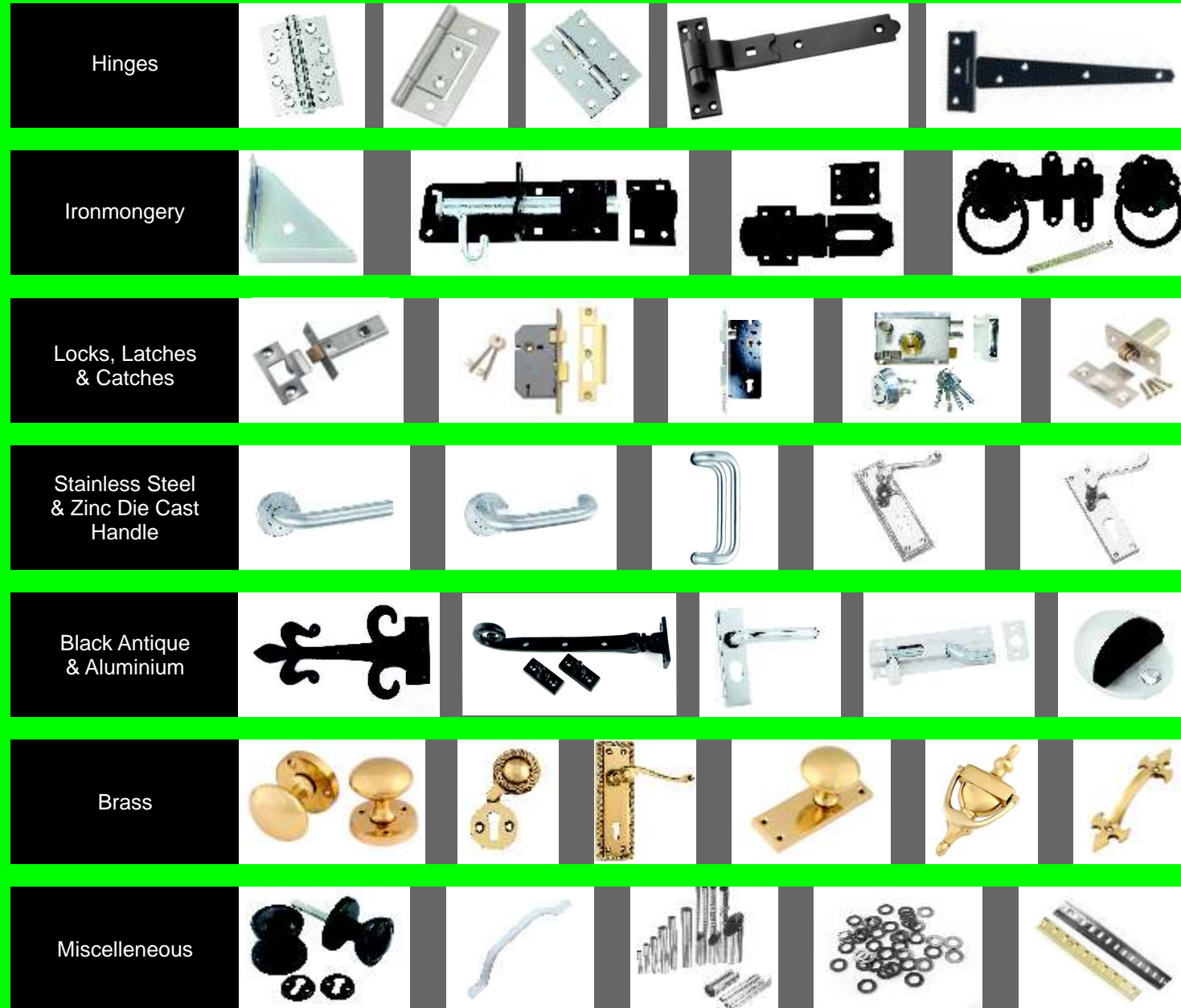

*Garg*

ISO 9001 : 2008 CERTIFIED COMPANY

# Fencing & Field Gate Hardware

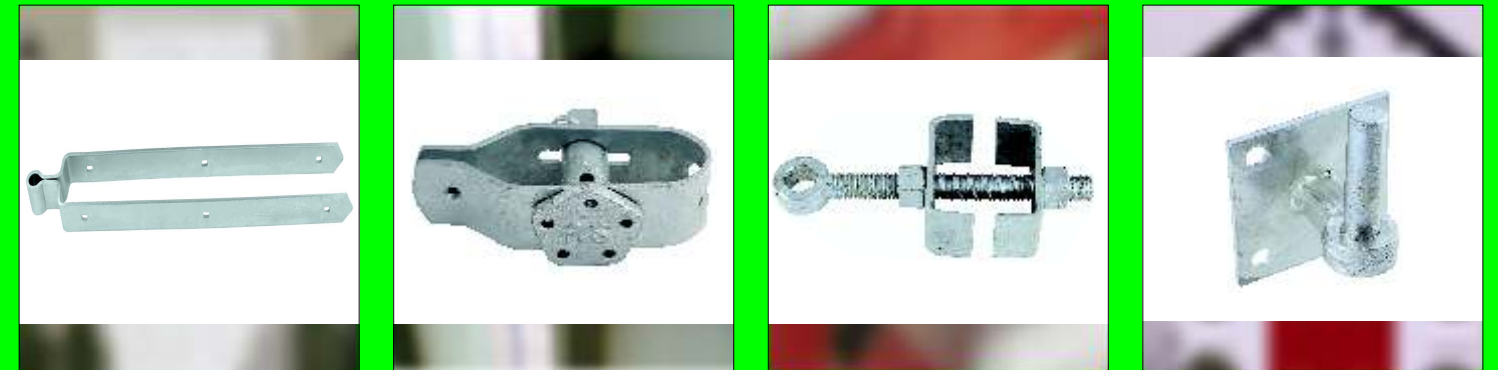

**D. P. GARG & CO. PVT. LTD.**

An ISO : 9001 : 2008 , 14001 : 2004, 18001 : 2007 Certified Company

A Government of India Recognised Star Export House

B-210 B, Phase - 2, Noida - 201305 (U.P.) INDIA

Ph.: +91-120-2460071, 2460085 to 87, 3290544, 3290445 Fax : +91-120-2460083, 2424519, 2424452

Email : [smg@garg-hinges.com](mailto:smg@garg-hinges.com)

Visit us at : [www.garg-hinges.com](http://www.garg-hinges.com), [www.garglocks.co.in](http://www.garglocks.co.in) , [www.elitelocks.co.in](http://www.elitelocks.co.in)



Quality the World Trusts



FIELD GATE HARDWARE FITTINGS

CODE	DESCRIPTION	PAGE	CODE	DESCRIPTION	PAGE
6002	FERRULE LOCKING STRAINER	01	1820	SQUARE SECTION GATE STAPLE TO DRIVE	14
1856	RATCHET STRAINER	01	1820E	STAPLE TO DRIVE	14
1845	LARGE RADISSEURS	01	1806	HOOK TO BOLT	14
1850	SMALL RADISSEURS	01	1896	GATE HANGER TO BOLT	14
1910	ANGLE CLEATS	02	1875	HOOK FOR BRICK WORK	15
1950	STRETCHER BARS	02	1803	HOOK TO DRIVE	15
1502	WEATHER BAR	02	1814A	HOOK ON SQUARE PLATE	15
1418	BARBED WIRE SPACERS	02	1814AH	ADJUSTABLE HOOK ON SQUARE PLATE	15
19912	GRAVEL CLEAT	03	435	HOOK ON NARROW PLATE	15
5002	BARBED WIRE BRACKET - FRONT FACE FIXING	03	1865H	GATE HOOK TO WELD (FLAT)	16
5002	BARBED WIRE BRACKET- SIDE FACE FIXING	03	1866H	GATE HOOK TO WELD (RADIUS)	16
1882	STAPLE ON PLATE	03	1865E	GATE EYE TO WELD (FLAT)	16
1884	RING ON PLATE	04	1866E	GATE HOOK TO WELD (RADIUS)	16
1880	HOOK ON PLATE	04	1809	FIELD GATE ADJUSTABLE EYE C/W BOLT 2 NUTS	17
1886	MANGER RING ON EYE BOLT	04	1809F	EYE BOLT WITH "U" CLIPS	17
452	WELDED EYE BOLTS	04	1812AS	FIELD GATE BOTTOM HINGE	18
453	UNWELDED EYE BOLT	05	1812AAS	SLOTTED BAND FOR ADJ. FIELD GATE HINGE	18
850	SINGLE POST HOOK	05	1812AL	FIELD GATE HINGE LONG BAND	18
851	DOUBLE POST HOOK	05	1820A	SPRING LATCH	18
454	LOOP NUT	05	1820B	SPRING KEEP	19
2404	BALUSTRADE BRACKET	06	1820C	SPRING CATCH	19
9604	TRELLIS CLIP	06	1860	CENTRAL CLOSING GATE CATCH	19
473-474-475	FENCING PANEL CLIPS	06	1820D	SINGLE LEG DRIVE CATCH	19
1164	GRAVEL BOARD BRACKET	06	1890B	FIELD GATE HINGE RISING S. BAND	19
4025	BIRD MOUTH	06	1890C	FIELD GATE HINGE RISING S. BAND	20
75002	ARRIS RAIL REPAIR BRACKET	07	1890A	FIELD GATE HINGE RISING S. BAND	20
8344	SLIP RAIL HOLDER	07	2430	POST RAMMER	20
8344	SLIP RAIL HOLDER	07	G0710	COWTIE HOOK	20
1897	SLIP RAIL BRACKET SET	07	1812	STANDARD FIELD GATE SET	21
8346	SLIP RAIL HALF ROUND HOLDER	08	1813	ADJUSTABLE FIELD GATE HINGE SET	21
851A	PANEL SECURITY BRACKET	08	1814	ADJUSTABLE HINGE SET WITH HOOK ON PLATE	21
9102	EXTENSION BASES	08	1817	STANDARD HINGE SET HOOKS ON PLATE	22
4568	SCREW IN PANEL CLIP	08	1820	SPRING LATCH HINGE SET	22
412	VINE EYE TO SCREW	09	2802	DOUBLE GATE FASTENER SET	22
9032	VINE EYE TO DRIVE	09			
1247	FLUTED ANGLE BRACKET	09			
1800GC	SELF LOCKING GATE CATCH ONLY	09			
1800SS	SELF LOCKING GATE CATCH - STRIKER-STRAIGHT	10			
1800CS	SELF LOCKING GATE CATCH - STRIKER- CRANKED	10			
1800DLS	STRIKER DOUBLE LEG	10			
1800	SELF LOCKING GATE CATCH (WITH STRIKER & C/W)	10			
1805	HUNTING TYPE GATE CATCH	10			
1000	SAFETY GATE HOOKS AND EYES	11			
1810	THROWOVER GATE LOOPS	11			
1810	THROWOVER GATE LOOPS	11			
1816	THROWOVER GATE LOOPS WITH LIFT HANDLE	11			
1816LHS	THROWOVER GATE LOOPS WITH LOCKING HASP STAPLE	12			
9002	GRAVITY CATCH FOR WOODEN POST	12			
1870	CAST GRAVITY CATCH	12			
406	DEVON GATE DROPS	12			
G0122	ROUND GATE DROPS	13			
1830	KICK OVER GATE LATCH	13			
1830A	KICK OVER STABLE LATCH	13			
6252	DOOR STAPLES	13			

ALL WEIGHT GIVEN IN KGS. & LENGTHS IN MM UNLESS MENTIONED

**6002 : FERRULE LOCKING STRAINER**

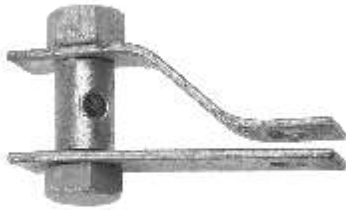

ITEM CODE	LENGTH	WIDTH	THICKNESS	BOLT No.	WT/PCS	Pcs In Inner	Pcs In Outer
MMIH6002090	93	53	2.6	M12	0.174	25	100

FINISH AVAILABLE : BZP, EXB ,HSG,DUROSIL

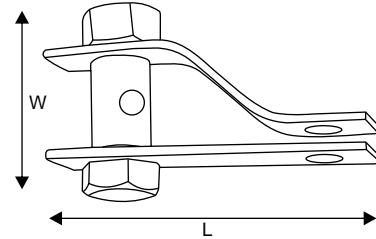

**1856 : RATCHET STRAINER**



ITEM CODE	LENGTH	WIDTH	THICKNESS	WT/Pcs	Pcs In Inner	Pcs In Outer
MMIH1856080	80	82	2.0	0.430	10	50

FINISH AVAILABLE : BZP, EXB ,HSG,DUROSIL

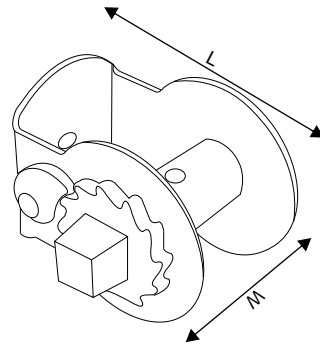

**1845 : LARGE RADISSEURS**

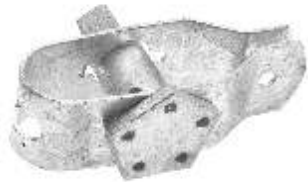

ITEM CODE	LENGTH	WIDTH	THICKNESS	WT/PCS	PCS IN INNER	PCS IN OUTER
MGFI1845XXX	127	38	2.5	0.393	50	50
MGFI1845XXX	127	38	3.0	0.430	50	50

FINISH AVAILABLE : BZP, EXB ,HSG,DUROSIL

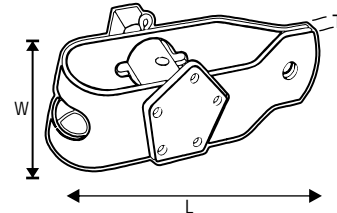

**1850 : SMALL RADISSEURS**



ITEM CODE	LENGTH	WIDTH	THICKNESS	WT/PCS	PCS IN INNER	PCS IN OUTER
MGFI1850XXX	102	32	2.5	0.214	50	50

FINISH AVAILABLE : BZP, EXB ,HSG,DUROSIL

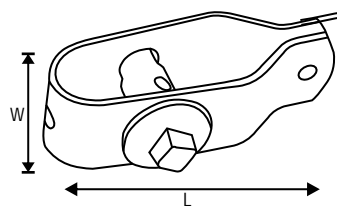

**1910 : ANGLE CLEATS**



ITEM CODE	L1xL2	WIDTH	THICKNESS	SLOT SIZE	WT/PCS	PCS IN INNER BOX	PCS IN OUTER BOX
MGFI1910038	40x40	38	4.5	20x11	0.073	20	200
MGFI1910040	40x65	38	5.0	20x11	0.119	10	150
MGFI1910050	50x50	50	5.0	30x11	0.152	10	100
MGFI1910075	40x75	40	6.0	30x11	0.191	10	80
MGFI1910125	50x75	50	6.0	30x11	0.264	10	60

FINISH AVAILABLE : BZP, EXB ,HSG,DUROSIL

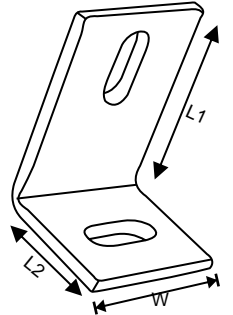

**1950 : STRETCHER BARS**



ITEM CODE	LENGTH	WIDTH	THICKNESS	SLOT SIZE	SLOT POSITION	WT/PCS	PCS IN INNER BOX	PCS IN OUTER BOX
MGFI1950450	460	25	5.0	20x11	200	0.422	10	10
MGFI1950900	920	20	5.0	20x11	430	0.650	10	10
MGFI1950950	950	25	5.0	20x11	430	0.878	10	10
MGFI1951400	1410	20	5.0	20x11	680	1.410	10	10

FINISH AVAILABLE : BZP, EXB ,HSG, DUROSIL

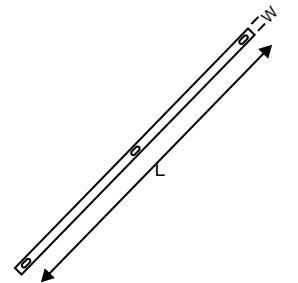

**1502 : WEATHER BAR**



ITEM CODE	LENGTH	WIDTH	THICKNESS	WT/PCS	Pcs In Inner	Pcs In Outer
MGFI2506140	1000	25	5.0	0.990	10	10
MGFI2505140	1000	25	6.0	1.177	10	10
MGFI3006140	1000	30	6.0	1.325	10	10
MGFI3005140	1000	30	5.0	1.177	10	10

AVAILABLE LENGHT : UP TO 2 Mtr  
FINISH AVAILABLE : EXB ,HSG, DUROSIL

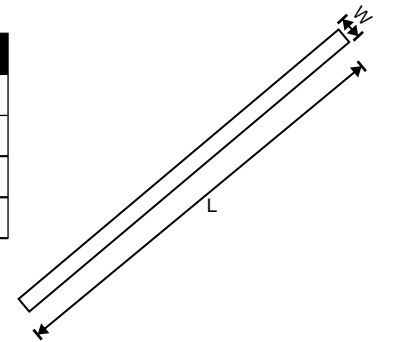

**1418 : BARBED WIRE SPACERS**



ITEM CODE	LENGTH	WIDTH	THICKNESS	SLOT SIZE	WT/PCS	Pcs In Inner	Pcs In Outer
MMIH1418460	460	25	5.0	20X11	0.406	10	40

FINISH AVAILABLE : BZP, EXB, HSG,DUROSIL

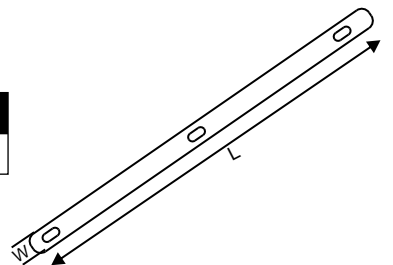

**19912 : GRAVEL CLEAT**



ITEM CODE	LENGTH	WIDTH	THICKNESS	Pin Dia	SHOOTS SIZE	WT/PCS	Pcs In Inner	Pcs In Outer
MGFI1951150	152	50	5.0	10	24x11	0.312	10	50
MGFI1951300	306	50	5.0	10	28x12	0.615	5	30

FINISH AVAILABLE : EXB ,HSG,DUROSIL

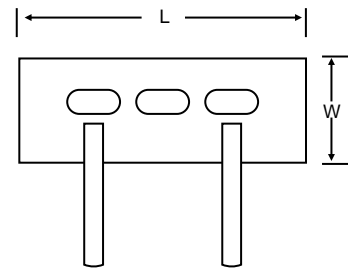

**5002 : BARBED WIRE BRACKET- FRONT FACE FIXING**



ITEM CODE	LENGTH	WIDTH	THICKNESS	Screw No.	WT/PCS	Pcs In Inner	Pcs In Outer
MGFI5002381	384	38	6.0	10	1.230	5	5

FINISH AVAILABLE : BZP, EXB ,HSG,DUROSIL

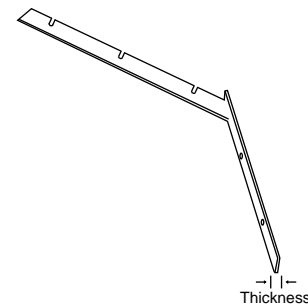

**5002 : BARBED WIRE BRACKET- SIDE FACE FIXING**



ITEM CODE	LENGTH	WIDTH	THICKNESS	Screw No.	WT/PCS	Pcs In Inner	Pcs In Outer
MGFI5002381	384	38	6.0	10	1.230	5	5

FINISH AVAILABLE : BZP, EXB ,HSG,DUROSIL

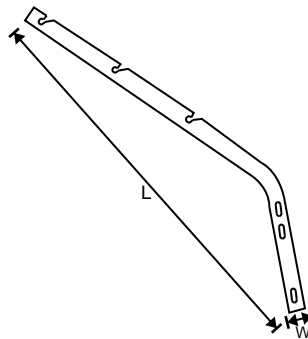

**1882 : STAPLE ON PLATE**



ITEM CODE	LENGTH	WIDTH	THICKNESS	SCREW No.	WT/PCS	PCS IN INNER BOX	PCS IN OUTER BOX
MGFI1882050	50	50	5.0	10	0.092	10	200

FINISH AVAILABLE : BZP,EXB ,HSG,DUROSIL

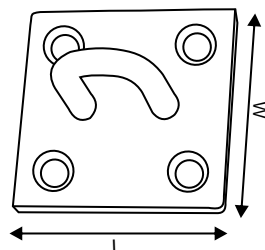

**1884 : RING ON PLATE**



ITEM CODE	LENGTH	WIDTH	THICKNESS	SCREW NO.	WT/PCS	Pcs In Inner	Pcs In Outer
MGFI1884050	50	50	5.0	10	0.180	10	100

FINISH AVAILABLE : BZP, EXB,HSG, DUROSIL

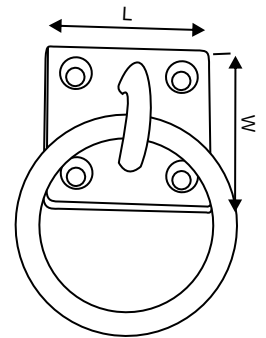

**1880 : HOOK ON PLATE**



ITEM CODE	LENGTH	WIDTH	THICKNESS	SCREW No.	WT/PCS	PCS IN INNER BOX	PCS IN OUTER BOX
MGFI1880050	50	50	5.0	10	0.129	10	140

FINISH AVAILABLE : BZP,EXB, HSG,SC

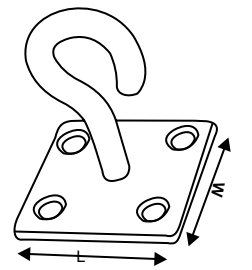

**1886: MANGER RING ON EYE BOLT**



ITEM CODE	LENGTH	RING DIA	RING WIRE DIA	ROD DIA	WT/PCS	PCS IN INNER BOX	PCS IN OUTER BOX
MGFI1886125	135	75	10	8.5	0.175	10	100
MGFI1886175	185	75	10	8.5	0.196	10	80
MGFI1886200	235	75	10	8.5	0.317	5	60
MGFI1886275	285	75	10	8.5	0.336	5	50

FINISH AVAILABLE : BZP, EXB ,HSG,DUROSIL

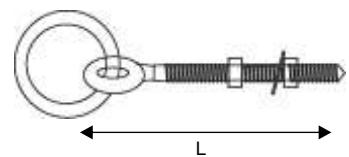

**452 : WELDED EYE BOLTS**



ITEM CODE	LENGTH	THREAD	THICKNESS	WT/PCS	PCS IN INNER BOX	PCS IN OUTER BOX
MGFI0452150	150	M6	1.8	0.109	10	160
MGFI0452200	200	M8	1.8	0.131	10	140
MGFI0452250	250	M10	1.8	0.152	10	120
MGFI0452300	300	M10	1.8	0.174	10	100

FINISH AVAILABLE : BZP, EXB ,HSG,DUROSIL

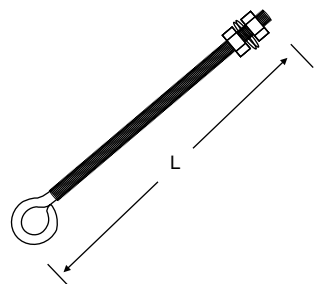

**453 : UNWELDED EYE BOLTS**



ITEM CODE	LENGTH	THREAD	THICKNESS	WT/PCS	Pcs In Inner	Pcs In Outer
MGFI0453150	150	M6	1.8	0.109	10	160
MGFI0453200	200	M8	1.8	0.131	10	140
MGFI0453250	250	M10	1.8	0.152	10	120
MGFI0453300	300	M10	1.8	0.174	10	100

FINISH AVAILABLE : BZP, EXB ,HSG,DUROSIL

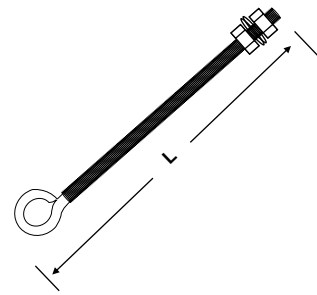

**850 : SINGLE POST HOOK**



ITEM CODE	LENGTH	WIDTH	BOLT	WT/PCS	PCS IN INNER BOX	PCS IN OUTER BOX
MGFI0850150	160	44	M10	0.164	10	100

FINISH AVAILABLE : BZP, EXB ,HSG,DUROSIL

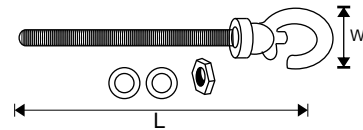

**851 : DOUBLE POST HOOK**



ITEM CODE	LENGTH	WIDTH	BOLT	WT/PCS	PCS IN INNER BOX	PCS IN OUTER BOX
MGFI0851150	160	44	M10	0.309	10	60

FINISH AVAILABLE : BZP, EXB ,HSG,DUROSIL

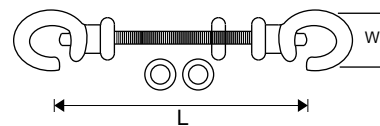

**454 : LOOP NUT**



ITEM CODE	LENGTH	DIA	WT/PCS	Pcs In Inner	Pcs In Outer
MGFI0454M10	42	37	0.066	20	200

FINISH AVAILABLE : BZP, EXB ,HSG,DUROSIL

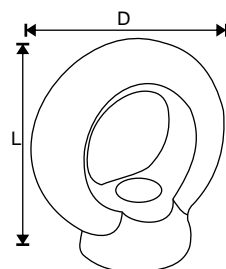

**2404 : BALUSTRADE BRACKET**



ITEM CODE	LENGTH	WIDTH	THICKNESS	SCREW No.	WT/PCS	Pcs In Inner	Pcs In Outer
MGFI2404040	40x40	30	2.0	5	0.034	50	500

FINISH AVAILABLE : BZP, EXB ,HSG,DUROSIL

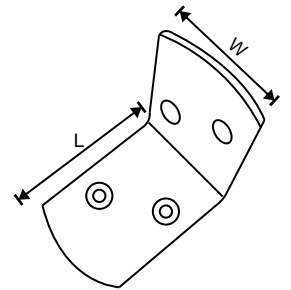

**9604 : TRELIS CLIP**



ITEM CODE	LENGTH	WIDTH	THICKNESS	SCREW No.	WT/PCS	Pcs In Inner	Pcs In Outer
MIRN9604060	59	59	1.5	8	0.048	25	400

FINISH AVAILABLE : BZP, EXB ,GALV

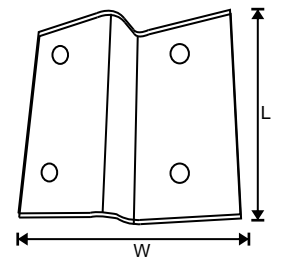

**473-474-475 : FENCING PANEL CLIPS**



ITEM CODE	LENGTH	WIDTH	HEIGHT	THICKNESS	WT/PCS	Pcs In Inner	Pcs In Outer
MGFI0473034	50	34	27	0.8	0.025	50	500
MGFI0474045	50	45	27	0.8	0.029	50	500
MGFI0475050	50	52	24	0.8	0.029	50	500

FINISH AVAILABLE : BZP, EXB ,HSG,DUROSIL

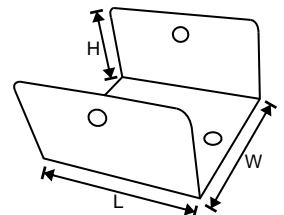

**1164 : GRAVEL BOARD BRACKET**

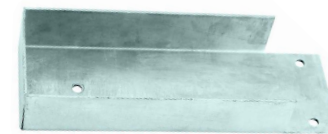

ITEM CODE	LENGTH	WIDTH	THICKNESS	SCREW No.	WT/PCS	Pcs In Outer
MGFI1164150	152	55	1.6	8	0.182	60

FINISH AVAILABLE : BZP, EXB ,HSG,DUROSIL

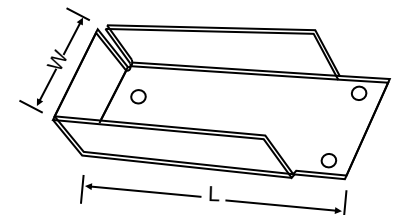

**4025 : BIRD MOUTH**



ITEM CODE	LENGTH	WIDTH	THICKNESS	HOLE DIA	WT/PCS	Pcs In Outer
MMIH4025100	250	90	0.7	4.2	0.241	60
MMIH4025150	250	140	0.75	4.2	0.413	40

FINISH AVAILABLE : BZP, EXB,GALV

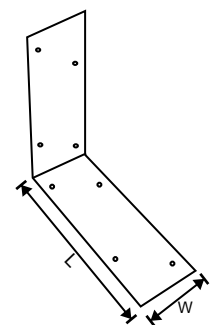

**75002 : ARRIS RAIL REPAIR BRACKET**



ITEM CODE	LENGTH	WIDTH	THICKNESS	HOLE DIA	WT/PCS	Pcs In Outer
MMIH7502100	111	70	0.8	5	0.110	100
MMIH7502220	226	60	0.8	5	0.168	80
MMIH7502350	322	60	0.8	5	0.270	60

FINISH AVAILABLE : BZP, EXB ,GALV

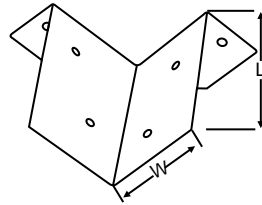

**8344 : SLIP RAIL HOLDER**



ITEM CODE	LENGTH	WIDTH	THICKNESS	SCREW No.	WT/PCS	Pcs In Outer
MGF18344050	235	62	6.0	10	0.365	10

FINISH AVAILABLE : BZP, EXB ,HSG,DUROSIL

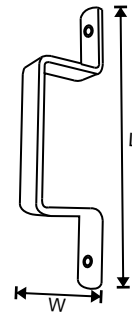

**8344 : SLIP RAIL HOLDER**



ITEM CODE	LENGTH	WIDTH	THICKNESS	SCREW No.	WT/PCS	Pcs In Outer
MGF18344075	235	75	6.0	10	0.431	10

FINISH AVAILABLE : BZP, EXB ,HSG,DUROSIL

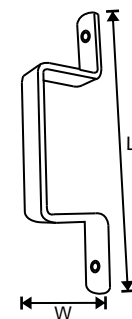

**1897 : SLIP RAIL BRACKET SET**



ITEM CODE	LENGTH	WIDTH	THICKNESS	SCREW No.	WT/PCS	Pcs In Inner	Pcs In Outer
MGF1897200	191	32	3.0	10	0.360	5	50

FINISH AVAILABLE : BZP, EXB ,HSG,DUROSIL

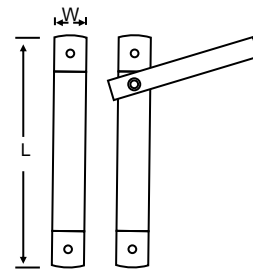

**8346 : SLIP RAIL HALF ROUND HOLDER**



ITEM CODE	LENGTH	WIDTH	THICKNESS	SCREW No.	WT/PCS	Pcs In Outer
MGF18346XXX	250	25	6.0	10	0.394	10

FINISH AVAILABLE : BZP, EXB ,HSG,DUROSIL

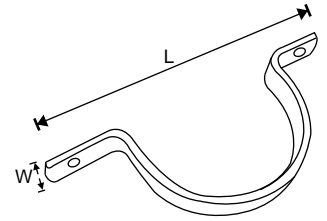

**851A : PANEL SECURITY BRACKET**



ITEM CODE	LENGTH	WIDTH	THICKNESS	SCREW No.	WT/PCS	Pcs In Outer
MGF1851AXXX	237	40	1.6	8	0.133	80

FINISH AVAILABLE : BZP, EXB ,HSG,DUROSIL

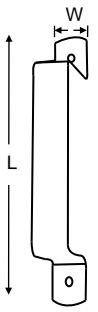

**9102 : EXTENSION BASES**



ITEM CODE	LENGTH	WIDTH	THICKNESS	SCREW No.	SLOT SIZE	WT/PCS	PCS IN INNER	PCS IN OUTER
MMIH910225	225	25	5.0	8	16x8	0.166	10	100

FINISH AVAILABLE : BZP, EXB ,HSG,DUROSIL

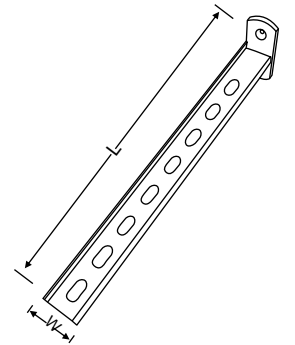

**4568 : SCREW IN PANEL CLIP**



ITEM CODE	LENGTH	WIDTH	THICKNESS	Screw No.	WT/PCS	Pcs In Inner	Pcs In Outer
MGF14568035	34x38	30	2.0	14x48	0.045	50	400

FINISH AVAILABLE : BZP, EXB ,HSG,DUROSIL

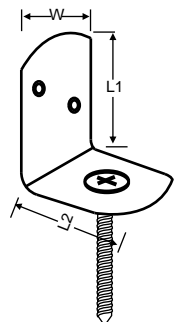

**412 : VINE EYES TO SCREW**



ITEM CODE	LENGTH	WIRE DIA	WT/PCS	PCS IN INNER	PCS IN OUTER
MMIH0412075	86	3.85	0.011	100	1000
MMIH0412100	111	3.85	0.013	100	1000
MMIH0412125	136	3.85	0.015	100	1000
MMIH0412150	160	3.85	0.017	100	1000



FINISH AVAILABLE : ZP, ZPYP, EB

**9032 : VINE EYE TO DRIVE**



ITEM CODE	LENGTH	WIDTH	THICKNESS	WT/Pcs	Pcs In Inner	Pcs In Outer
MMIH9032075	75	12	2.5	0.011	50	500
MMIH9032100	100	12	2.5	0.014	50	500
MMIH9032125	125	12	2.5	0.018	50	500
MMIH9032150	150	12	2.5	0.023	50	500

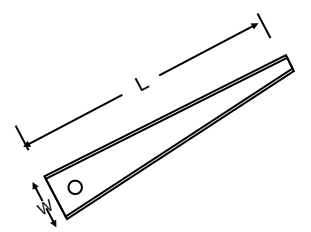

FINISH AVAILABLE : BZP, EXB

**1247 : FLUTED ANGLE BRACKET**



ITEM CODE	SIZE	LENGTH	WIDTH	THICKNESS	SCREW NO	WT/PCS	PCS IN INNER	PCS IN OUTER
MGFI1247075	2"x3"	50X75	20	3.7	8	0.140	20	101
MGFI1247100	3"x4"	75X100	20	3.7	8	0.150	20	142
MGFI1247125	4"x5"	100X125	20	3.7	8	0.175	20	175
MGFI1247150	6"x8"	150X200	25	5.0	8	0.347	20	347
MGFI1247200	8"x10"	200X250	25	5.0	8	0.427	20	427
MGFI1247250	10"x12"	250X300	25	5.0	8	0.551	20	550
MGFI1247300	12"x14"	300X350	25	5.0	8	0.692	20	692

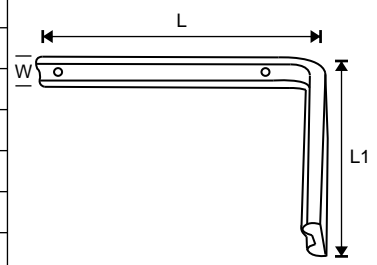

FINISH AVAILABLE - EXB, TEXTURE BLK, EXW, ZP, DUROSIL, EVERBLACK, HSG

**1800GC : SELF LOCKING GATE CATCH ONLY**



ITEM CODE	LENGTH	WIDTH	PEG DIAMETER	THICKNESS	COACH SCREW	WT/Pcs	Pcs In Inner	Pcs In Outer
MGFI1801175	180	32	12.30	6.0	10x75	0.780	5	20

FINISH AVAILABLE - BZP, EXB, HSG, DUROSIL

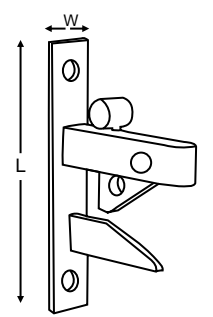

**1800SS : SELF LOCKING GATE CATCH STRIKER - STRAIGHT**



ITEM CODE	LENGTH	WIDTH	ROD DIA	WT/Pcs	Pcs In Inner	Pcs In Outer
MGFI1804191	185	40	12.5	0.240	10	80

FINISH AVAILABLE - EXB, BZP, EXB, HSG, DUROSIL

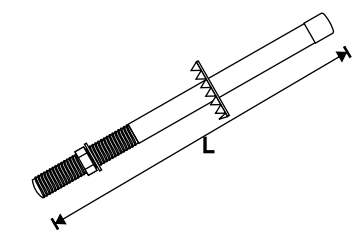

**1800CS : SELF LOCKING GATE CATCH STRIKER - CRANKED**



ITEM CODE	LENGTH	WIDTH	ROD DIA	WT/Pcs	Pcs In Inner	Pcs In Outer
MGFI1802191	185	40	12.5	0.233	10	80

FINISH AVAILABLE - BZP, EXB, HSG, DUROSIL

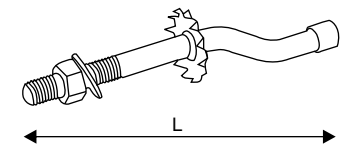

**1800DLS : STRIKER DOUBLE LEG**

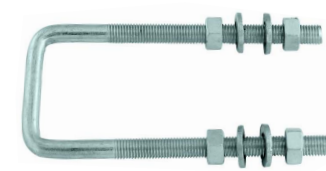

ITEM CODE	LENGTH	WIDTH	ROD DIA	THREAD	WT/PCS	PCS IN INNER	PCS IN OUTER
MGFI1848170	170	60	11.6	M12	0.362	5	20

FINISH AVAILABLE : BZP, EXB, HSG, DUROSIL

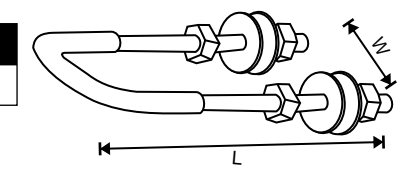

**1800 : SELF LOCKING GATE CATCH WITH STRIKER POLYBAGGED C/W FIXINGS**



DESCRIPTION	Set
ITEM CODE	MGFI1801175
SELF LOCKING GATE CATCH (1800GC)	1
CRANKED STRICKER ONLY (1800CS)	1
COACH SCREW (M10X75)	2
TOTAL WT. SET	1.080

FINISH AVAILABLE - EXB, BZP, EXB, HSG, DUROSIL

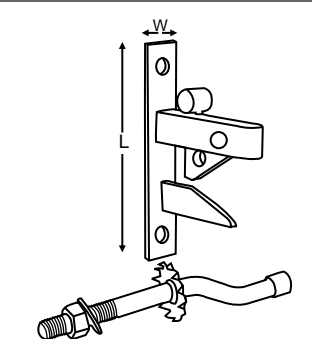

**1805 : HUNTING TYPE GATE CATCH**



ITEM CODE	LENGTH	WIDTH	ROD DIA	THICKNESS	COACH SCREW	WT/PCS	PCS IN INNER	PCS IN OUTER
MGFI1805XXX	180	32	16.0	6.0	10x75	1.360	2	20

FINISH AVAILABLE : EXB, BZP, HSG, DUROSIL

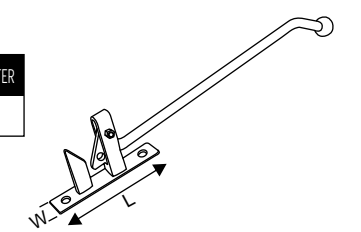

**1000 : SAFETY GATE HOOKS AND EYES**



ITEM CODE	LENGTH	WIDTH	THICKNESS	WT/PCS	PCS IN INNER BOX	PCS IN OUTER BOX
MGFI1000150	153	60	6.0	0.268	5	60

FINISH AVAILABLE : BZP, EXB ,HSG, DUROSIL

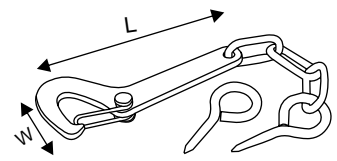

**1810 : THROWOVER GATE LOOPS**



ITEM CODE	LENGTH	WIDTH	THICKNESS	CARRIAGE BOLT	WT/PCS	PCS IN INNER	PCS IN OUTER
MGFI1810175	170	80	5.0	M10	0.404	5	40

FINISH AVAILABLE : BZP, EXB ,HSG,DUROSIL

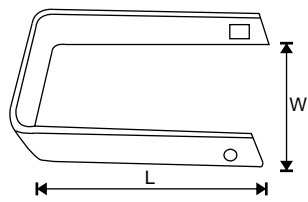

**1810 : THROWOVER GATE LOOPS**



ITEM CODE	LENGTH	WIDTH	THICKNESS	CARRIAGE BOLT	WT/PCS	PCS IN INNER	PCS IN OUTER
MGFI1810350	360	80	5.0	M10	0.970	2	10
MGFI0910400	410	80	5.0	M10	1.324	2	10
MGFI0910500	490	80	5.0	M10	1.324	2	10

FINISH AVAILABLE : BZP, EXB ,HSG,DUROSIL

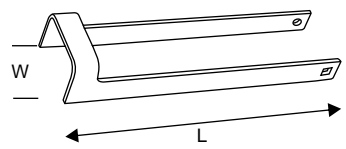

**1816 : THROWOVER GATE LOOP WITH LIFT HANDLE**



ITEM CODE	LENGTH	WIDTH	THICKNESS	CARRIAGE BOLT	WT/PCS	PCS IN OUTER
MGFI1816350	458	78	6.0	M10	2.592	5

FINISH AVAILABLE : BZP, EXB ,HSG,DUROSIL

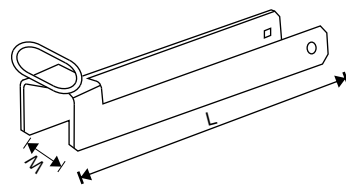

**1816 LHS : THROWOVER GATE LOOP WITH LOCKING HASP & STAPLE**



ITEM CODE	LENGTH	WIDTH	THICKNESS	CARRIAGE BOLT	WT/PCS	Pcs In Outer
MGFI2816450	456	80	6.0	M10 & 12	2.710	2

FINISH AVAILABLE : BZP, EXB ,HSG,DUROSIL

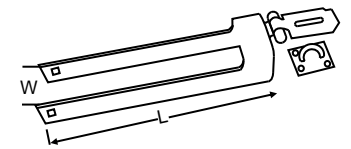

**9002 : GRAVITY CATCH FOR WOODEN POST**



ITEM CODE	LENGTH	WIDTH	THICKNESS	WT/PCS	Pcs In Inner	Pcs In Outer
MGFI18329275	270	70	6.0	0.689	5	25

FINISH AVAILABLE : BZP, EXB ,HSG,DUROSIL

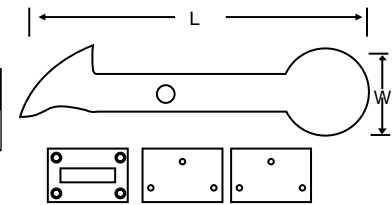

**1870 : CAST GRAVITY CATCH**



ITEM CODE	LENGTH	WIDTH	THICKNESS	CARRIAGE BOLT	WT/PCS	PCS IN INNER	PCS IN OUTER
MGFI1870240	240	320	20	M12	3.250	2	4

FINISH AVAILABLE : EXB ,HSG,DUROSIL

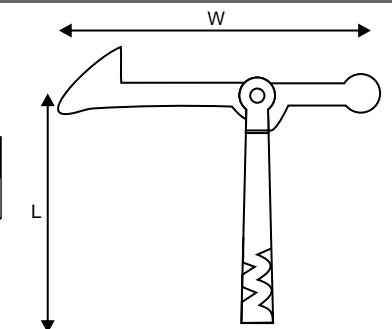

**406 : DEVON GATE DROPS**



ITEM CODE	LENGTH	WIDTH	THICKNESS	WT/PCS	PCS IN INNER	PCS IN OUTER
MGFI0406152	150	80	7.8	0.112	10	100

FINISH AVAILABLE : BZP, EXB ,HSG,DUROSIL

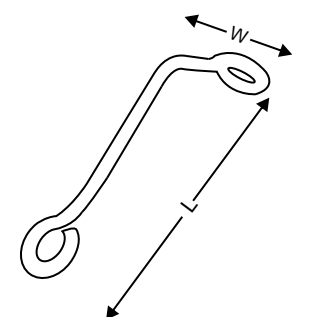



**G0122 : ROUND GATE DROPS**



ITEM CODE	LENGTH	WIDTH	ROD DIA	WT/PCS	PCS IN INNER	PCS IN OUTER
MGFI0122150	149	51	8.0	0.085	10	100

FINISH AVAILABLE : BZP, EXB ,HSG,DUROSIL

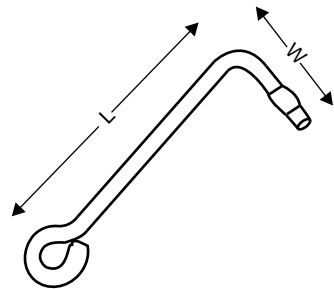

**1830 : KICK OVER GATE LATCH**

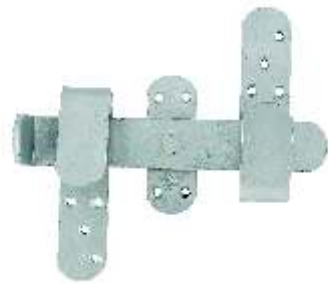

ITEM CODE	LENGTH	WIDTH	THICKNESS	SCREW No.	WT/PCS	PCS IN INNER	PCS IN OUTER
MGFI1830225	238	40	6.0	12	1.415	5	20

FINISH AVAILABLE : BZP, EXB ,HSG,DUROSIL

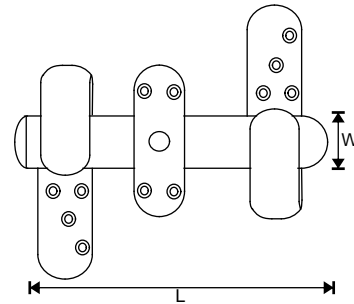

**1830A : KICK OVER STABLE LATCH**



ITEM CODE	LENGTH	WIDTH	THICKNESS	SCREW No.	WT/PCS	PCS IN INNER	PCS IN OUTER
MGFI1831225	250	50	6.0	10	1.610	2	10

FINISH AVAILABLE : BZP, EXB ,HSG,DUROSIL

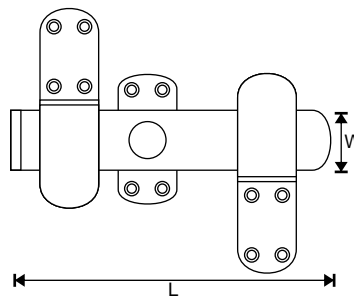

**6252: DOOR STAPLES**



ITEM CODE	LENGTH	WIDTH	Dia	WT/PCS	PCS In Inner	PCS In Outer
MGFI0408063	65	37	6	0.030	50	500
MGFI0408075	75	41	8	0.063	50	250
MGFI0408100	110	41	8	0.084	20	200

FINISH AVAILABLE : BZP, EXB ,HSG,DUROSIL

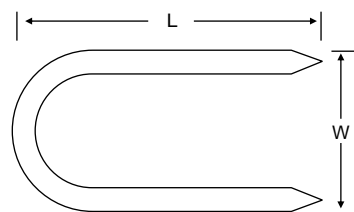

**1820 : SQUARE SECTION GATE STAPLE TO DRIVE**



ITEM CODE	LENGTH	WIDTH	SQUARE	WT/PCS	Pcs In Inner	Pcs In Outer
MGFI1823100	125	104	10	0.215	20	80

FINISH AVAILABLE : BZP, EXB ,HSG,DUROSIL

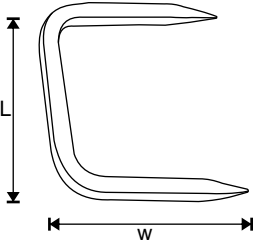

**1820 E : STAPLE TO DRIVE**



ITEM CODE	LENGTH	WIDTH	DIA	WT/PCS	PCS IN INNER	PCS IN OUTER
MGFI1823100	125	104	10	0.215	20	60

FINISH AVAILABLE : BZP, EXB ,HSG,DUROSIL

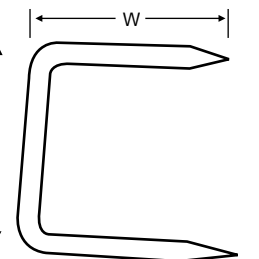

**1806 : HOOK TO BOLT**



ITEM CODE	LENGTH	WIDTH	PIN DIA	THREAD	WT/PCS	PCS IN INNER	PCS IN OUTER
MGFI1806250	280	42	19	3/4"	0.885	5	20
MGFI1806327	330	42	19	3/4"	1.144	5	20

FINISH AVAILABLE : BZP, EXB ,HSG,DUROSIL

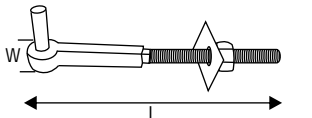

**1896 : GATE HANGER TO BOLT**



ITEM CODE	LENGTH	WIDTH	THICKNESS	Pin Dia	WT/Pcs	PCS In Inner	PCS In Outer
MGFI1896200	200	75	19	19	0.850	10	10
MGFI1896250	260	75	19	19	1.000	10	10
MGFI1896350	360	75	19	19	1.230	10	10
MGFI1896400	410	75	19	19	1.300	10	10
MGFI1896450	460	75	19	19	1.390	10	10

FINISH AVAILABLE : BZP, EXB ,HSG,DUROSIL

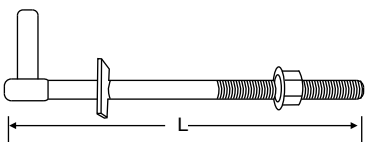

**1875 : HOOK FOR BRICK WORK**



ITEM CODE	Length	Width	Thickness	PIN DIA	WT/Pcs	Pcs In Inner	Pcs In Outer
MGF11875XXX	160	20	6.0	12.7	0.367	10	50
MGF11875XXX	275	20	6.0	12.7	0.631	10	30
MGF11875XXX	160	25	6.0	19.0	0.800	5	20
MGF11875XXX	275	25	6.0	19.0	0.918	5	15

FINISH AVAILABLE : BZP,EXB ,HSG,DUROSIL

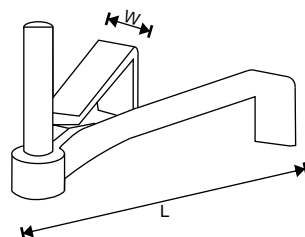

**1803 : HOOK TO DRIVE**



ITEM CODE	LENGTH	WIDTH	PIN DIA	WT/PCS	PCS IN INNER BOX	PCS IN OUTER BOX
MGF11803200	216	41	19	0.756	5	30

FINISH AVAILABLE : BZP, EXB ,HSG,DUROSIL

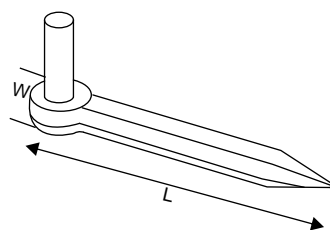

**1814A : HOOK ON SQUARE PLATE**



ITEM CODE	LENGTH	WIDTH	THICKNESS	COACH SCREW	WT/PCS	PCS IN INNER BOX	PCS IN OUTER BOX
MGF11834100	100	100	5.0	M10	0.775	5	20

FINISH AVAILABLE : BZP, EXB ,HSG,DUROSIL

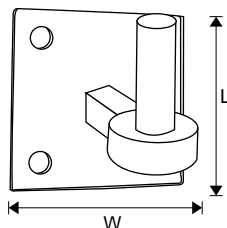

**1814AH : ADJUSTABLE HOOK ON SQUARE PLATE**



ITEM CODE	LENGTH	WIDTH	THICKNESS	PIN DIA	Coach Screw	WT/PCS	PCS IN INNER BOX	PCS IN OUTER BOX
MGF11815101	100	100	5.0	19.0	10x75	0.900	5	20

FINISH AVAILABLE : BZP, EXB ,HSG,DUROSIL

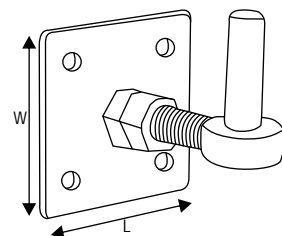

**435 : HOOK ON NARROW PLATE**



ITEM CODE	LENGTH	WIDTH	THICKNESS	PIN DIA	COACH SCREW	WT/PCS	Pcs In Inner	Pcs In Outer
MGF10435200	205	50	8.0	24	M12	1.130	20	250

FINISH AVAILABLE - EXB,BZP,HSG

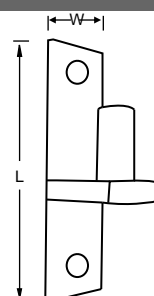

**1865H : GATE HOOK TO WELD (FLAT)**



ITEM CODE	LENGTH	WIDTH	THICKNESS	PIN DIA	WT/PCS	PCS IN INNER BOX	PCS IN OUTER BOX
MGF11867012	40	25	10	12	0.093	20	200
MGF11867016	63	46	16	16	0.400	10	40
MGF11867019	63	46	16	19	0.440	5	40
MGF11867022	63	46	16	22	0.479	5	40
MGF11867024	63	46	16	25	0.503	5	30

FINISH AVAILABLE : EXB ,HSG, DUROSIL

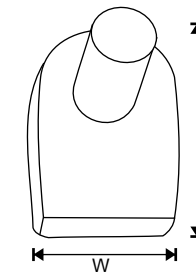

**1866H GATE HOOK TO WELD (RADIUS)**



ITEM CODE	LENGTH	WIDTH	THICKNESS	PIN DIA	WT/PCS	PCS IN INNER	PCS IN OUTER
MGF11868012	40	25	10	12	0.093	20	200
MGF11868016	63	46	16	16	0.400	10	40
MGF11868019	63	46	16	19	0.440	5	40
MGF11868022	63	46	16	22	0.479	5	40
MGF11868024	63	46	16	25	0.503	5	30

FINISH AVAILABLE : EXB ,HSG, DUROSIL

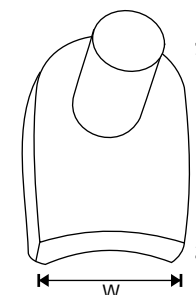

**1865E : GATE EYE TO WELD (FLAT)**



ITEM CODE	LENGTH	WIDTH	THICKNESS	HOLE DIA	WT/PCS	PCS IN INNER BOX	PCS IN OUTER BOX
MGF11865012	40	25	10	13	0.060	20	250
MGF11865016	63	46	16	17	0.340	10	60
MGF11865019	63	46	16	20	0.300	10	60
MGF11865022	63	46	16	23	0.246	10	60
MGF11865025	63	46	16	26	0.200	10	60

FINISH AVAILABLE : EXB ,HSG, DUROSIL

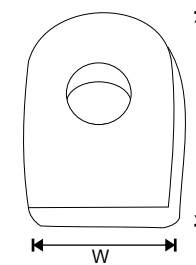

**1866E GATE EYE TO WELD (RADIUS)**



ITEM CODE	LENGTH	WIDTH	THICKNESS	HOLE DIA	WT/PCS	PCS IN INNER BOX	PCS IN OUTER BOX
MGF11866012	40	25	10	13	0.060	20	250
MGF11866016	63	46	16	17	0.340	10	60
MGF11866019	63	46	16	20	0.300	10	60
MGF11866022	63	46	16	23	0.246	10	60
MGF11866026	63	46	16	26	0.200	10	25

FINISH AVAILABLE : EXB ,HSG, DUROSIL

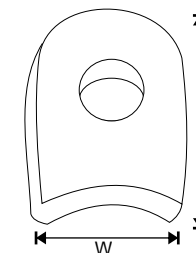

1809 : FIELD GATE ADJUSTABLE EYE C/W 2 NUTS



ITEM CODE	LENGTH	WIDTH	THICKNESS	HOLE DIA	THREAD	WT/PCS	PCS IN INNER BOX	PCS IN OUTER BOX
MGF11709100	100	30	12	13	1/2"	0.163	5	100
MGF11709150	150	30	12	13	1/2"	0.200	5	80
MGF11709200	200	30	12	13	1/2"	0.237	5	60
MGF11709250	250	30	12	13	1/2"	0.274	5	60
MGF11710100	100	36	15	17	5/8"	0.231	5	80
MGF11710150	150	36	15	17	5/8"	0.329	5	40
MGF11710200	200	36	15	17	5/8"	0.377	5	40
MGF11710250	250	36	15	17	5/8"	0.425	5	40
MGF11711100	100	42	17.5	20	3/4"	0.437	5	40
MGF11711150	150	42	17.5	20	3/4"	0.513	5	30
MGF11711200	200	42	17.5	20	3/4"	0.589	5	30
MGF11711250	250	42	17.5	20	3/4"	0.665	5	20
MGF11711300	300	42	17.5	20	3/4"	0.741	5	20
MGF11712100	100	42	17.5	23	3/4"	0.426	5	30
MGF11712150	150	42	17.5	23	3/4"	0.502	5	20
MGF11712200	200	42	17.5	23	3/4"	0.578	5	20
MGF11712250	250	42	17.5	23	3/4"	0.654	5	20
MGF11713300	300	42	17.5	23	3/4"	0.730	5	20
MGF11713100	100	56	24	26	1"	0.850	5	5
MGF11713150	150	56	24	26	1"	1.008	5	5
MGF11713200	200	56	24	26	1"	1.198	5	5
MGF11713250	250	56	24	26	1"	1.388	5	5
MGF11713300	300	56	24	26	1"	1.578	5	5

FINISH AVAILABLE : BZP, EXB ,HSG,DUROSIL

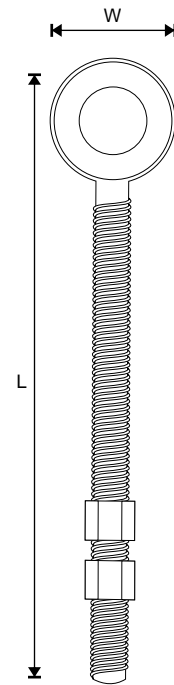

1812AS : FIELD GATE BOTTOM HINGE



ITEM CODE	LENGTH	WIDTH	THICKNESS	WT/PCS	PCS IN INNER BOX	PCS IN OUTER BOX
MGF11832125	180	78	6.0	0.876	5	30

FINISH AVAILABLE : BZP, EXB ,HSG,DUROSIL  
ALSO ABAILABLE IN 5MM THICKNESS

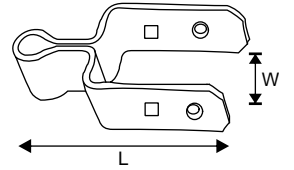

1812AAS : SLOTTED BAND FOR ADJUSTABLE FIELD GATE HINGE



ITEM CODE	LENGTH	WIDTH	THICKNESS	WT/PCS	PCS IN INNER BOX	PCS IN OUTER BOX
MGF11821125	184	77	6.0	0.887	5	20

FINISH AVAILABLE : BZP, EXB ,HSG,DUROSIL  
ALSO ABAILABLE IN 5MM THICKNESS

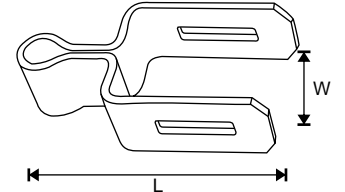

1812 AL : FIELD GATE HINGE LONG BAND



ITEM CODE	LENGTH	WIDTH	THICKNESS	SCREW No	WT/PCS	Pcs In Inner	Pcs In Outer
MGF11825300	330	78	6.0	M10	1.486	2	2
MGF11825450	480	78	6.0	M10	2.274	2	2
MGF11825600	630	78	6.0	M10	3.000	2	2

FINISH AVAILABLE : BZP, EXB ,HSG,DUROSIL  
ALSO ABAILABLE IN 5MM THICKNESS

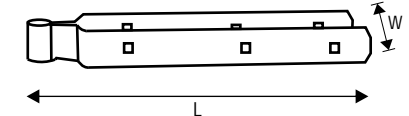

1809F : EYE BOLT WITH 'U' CLIPS



ITEM CODE	LENGTH	WIDTH	THICKNESS	THREAD	WT/PCS	PCS IN INNER BOX	PCS IN OUTER BOX
MGF11723250	254	50	6.0	3/4"	1.235	5	5

FINISH AVAILABLE : BZP, EXB ,HSG,DUROSIL

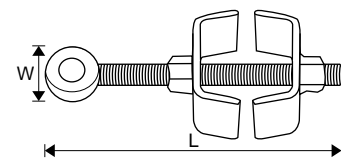

1820A : SPRING LATCH



ITEM CODE	LENGTH	WIDTH	THICKNESS	CARRIAGE BOLT	WT/PCS	PCS IN INNER BOX	PCS IN OUTER BOX
MGF11826600	590	45	4.0	M8	0.905	5	15

FINISH AVAILABLE : BZP, EXB ,HSG,DUROSIL

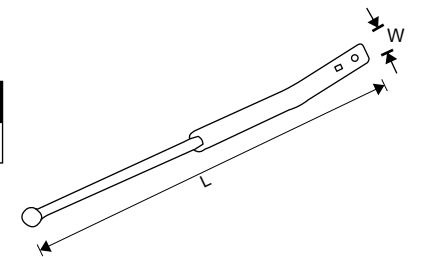

**1820B : SPRING KEEP**



ITEM CODE	LENGTH	WIDTH	THICKNESS	ScrewNo.	WT/PCS	Pcs In Inner	Pcs In Outer
MGF11827225	238	76	5.0	12	0.492	5	30

FINISH AVAILABLE : BZP, EXB ,HSG,DUROSIL

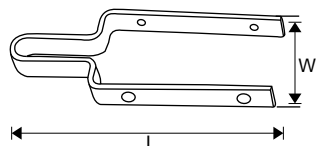

**1820C : SPRING CATCH**



ITEM CODE	LENGTH	WIDTH	THICKNESS	SQUARE	WT/PCS	PCS IN INNER BOX	PCS IN OUTER BOX
MGF11828200	212	60	10.0	12.0	0.455	5	30

FINISH AVAILABLE : BZP, EXB ,HSG,DUROSIL

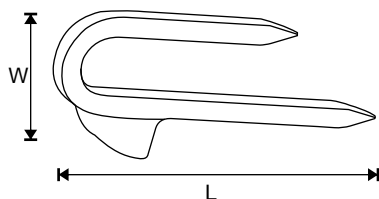

**1860 : CENTRAL CLOSING GATE CATCH**

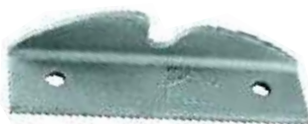

ITEM CODE	LENGTH	WIDTH	THICKNESS	COACH SCREW	WT/PCS	PCS IN INNER	PCS IN OUTER
MGF11860175	151	40	5.0	10	0.350	5	50

FINISH AVAILABLE : BZP, EXB ,HSG, DUROSIL

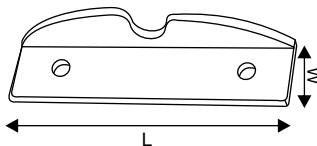

**1820D : SINGLE LEG DRIVER CATCH**



ITEM CODE	LENGTH	WIDTH	THICKNESS	WT/PCS	PCS IN INNER BOX	PCS IN OUTER BOX
MGF11824200	209	38	10	0.342	5	30

FINISH AVAILABLE : BZP, EXB ,HSG,DUROSIL

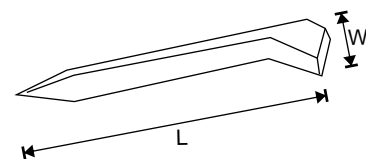

**1890B : FIELD GATE HINGE RISING S. BAND**



ITEM CODE	LENGTH	WIDTH	THICKNESS	SCREW No.	WT/PCS	PCS IN INNER BOX	PCS IN OUTER BOX
MGF11895150	152	152	6.0	14	1.926	2	4

FINISH AVAILABLE : BZP, EXB ,HSG,DUROSIL

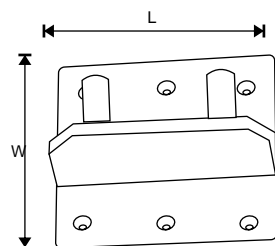

**1890C : FIELD GATE HINGE RISING S. BAND**



ITEM CODE	LENGTH	WIDTH	THICKNESS	THREAD	WT/PCS	PCS IN INNER BOX	PCS IN OUTER BOX
MGF11896200	200	147	10/22	M12	2.522	2	2

FINISH AVAILABLE : BZP, EXB ,HSG,DUROSIL

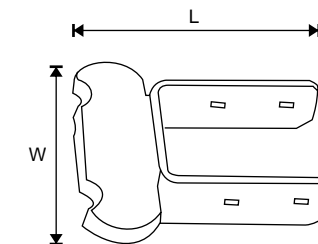

**1890A : FIELD GATE HINGE RISING S.BAND**



FINISH AVAILABLE : BZP, EXB ,HSG,DUROSIL

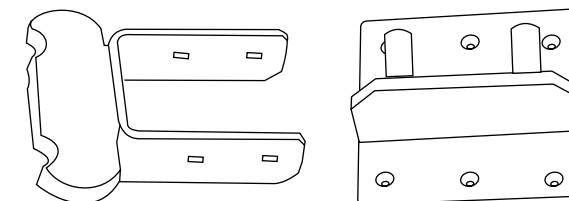

**2430 : POST RAMMER**



ITEM CODE	LENGTH	WIDTH	BIG PIPE DIA	WT/PCS	Pcs In Inner	Pcs In Outer
MGF12430150	830	320	150	19.300	1	1

FINISH AVAILABLE - EXB

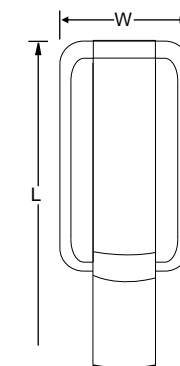

**G0710 COWTIE HOOK**



ITEM CODE	LENGTH	WIDTH	DIAMETER	WT/PCS	Pcs In Inner	Pcs In Outer
CMIH071073	72	27	9.0	0.060	20	250

FINISH AVAILABLE - EXB,

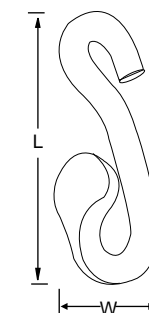

1812 : STANDARD FIELD GATE SET



DESCRIPTION	300 MM	450 MM	600 MM
ITEM CODE	MGFI1812300	MGFI1812450	MGFI1812600
TOP BAND (1812AL)	1	1	1
BOTTOM BAND (1812AS)	1	1	1
HOOK TO BOLT (1806)	1	1	1
HOOK TO DRIVE(1803)	1	1	1
CARRIAGE BOLT M10x110	3	4	4
SCREW 12x1.25"	2	2	2
TOTAL Wt. SET:	4.514	5.383	6.109

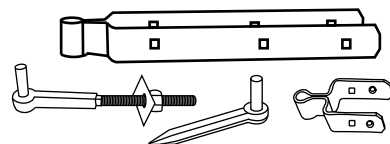

FINISH AVAILABLE : BZP, EXB ,HSG,DUROSIL  
ALSO AVAILABLE LIGHTER VERSION 5 MM THICKNESS

1817 : STANDARD HINGE SET HOOKS ON PLATE



DESCRIPTION	300 MM	450 MM	600 MM
ITEM CODE	MGFI1817300	MGFI1817450	MGFI1817600
TOP BAND(1812AL)	1	1	1
BOTTOM BAND (1812AS)	1	1	1
HOOK ON PLATE 4X4(1814A)	2	2	2
CARRIAGE BOLTS WITH NUT	3	4	4
COACH SCREW M10X75	8	8	8
SCREW 12x1.25"	2	2	2
TOTAL Wt. SET:	4.472	5.341	6.060

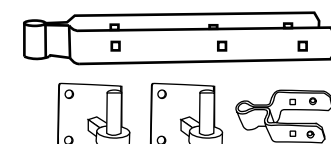

FINISH AVAILABLE : BZP, EXB ,HSG,DUROSIL  
ALSO AVAILABLE LIGHTER VERSION 5 MM THICKNESS

1813 : ADJUSTABLE FIELD GATE HINGE SET



DESCRIPTION	300 MM	450 MM	600 MM
ITEM CODE	MGFI1813300	MGFI1813450	MGFI1813600
TOP BAND (1812AL)	1	1	1
HOOK TO BOLT (1806)	1	1	1
HOOK TO DRIVE (1803)	1	1	1
ADJUSTABLE EYE WITH U CLIP (1809F)	1	1	1
CARRIAGE BOLT (M10X110)	2	3	3
TOTAL Wt. SET:	4.785	5.655	6.380

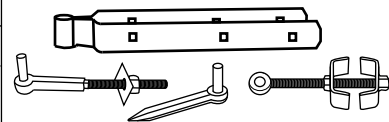

FINISH AVAILABLE : BZP, EXB ,HSG,DUROSIL  
ALSO AVAILABLE LIGHTER VERSION 5 MM THICKNESS

1820 : SPRING LATCH HINGE SET



DESCRIPTION	Set
ITEM CODE	MGFI1820600
SPRING LATCH	1
SPRING KEEP	1
SPRING CATCH	1
CARRIAGE BOLTS (M8x110)	1
SCREW 12x1.25"	5
TOTAL Wt. SET :	1.950

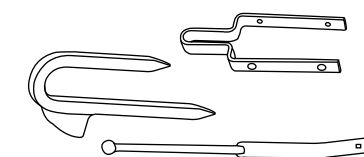

FINISH AVAILABLE : BZP, EXB ,HSG,DUROSIL

1814 : ADJUSTABLE HINGE SET WITH HOOK ON PLATE



DESCRIPTION	300 MM	450 MM	600 MM
ITEM CODE	MGFI1814300	MGFI1814450	MGFI1814600
TOP BAND (1812AL)	1	1	1
EYE BOLT WITH U CLIP(1809F)	1	1	1
HOOK ON SQUARE PLATE 4X4 (1814A)	2	2	2
CARRIAGE BOLTS M10X110	2	3	3
COACH SCREW M10X75	8	8	8
TOTAL Wt. SET:	4.742	5.612	6.338

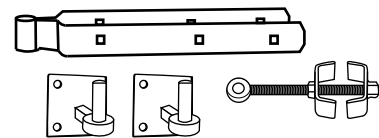

FINISH AVAILABLE : BZP, EXB ,HSG,DUROSIL  
ALSO AVAILABLE LIGHTER VERSION 5 MM THICKNESS

2802 : DOUBLE GATE FASTENER SET

DESCRIPTION	Set
ITEM CODE	MGFI2802450
THROWOVER14" (1810)	1
DOOR BOLT18"(XXX)	1
CARRIAGE BOLTS (M8x110)	1
SCREW 10x1.25"	14
TOTAL Wt. SET :	2.395

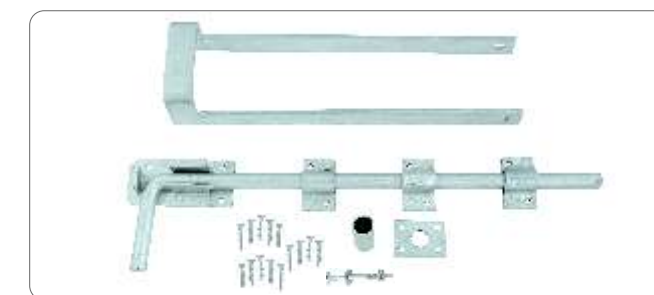

FINISH AVAILABLE : BZP, EXB ,HSG,DUROSIL



DESCRIPTION	PAGE No.	DESCRIPTION	PAGE No.
ADJUSTABLE FIELD GATE HINGE SET	21	LARGE RADISSEURS	1
ADJUSTABLE HINGE SET WITH HOOK ON PLATE	21	LOOP NUT	5
ADJUSTABLE HOOK ON SQUARE PLATE	15	MANGER RING ON EYE BOLT	4
ANGLE CLEATS	2	PANEL SECURITY BRACKET	8
ARRIS RAIL REPAIR BRACKET	7	POST RAMMER	20
BALUSTRADE BRACKET	6	RATCHET STRAINER	1
BARBED WIRE BRACKET - FRONT FACE FIXING	3	RING ON PLATE	4
BARBED WIRE BRACKET- SIDE FACE FIXING	3	ROUND GATE DROPS	13
BARBED WIRE SPACERS	2	SAFETY GATE HOOKS AND EYES	11
BIRD MOUTH	6	SCREW IN PANEL CLIP	8
CAST GRAVITY CATCH	12	SELF LOCKING GATE CATCH - STRIKER- CRANKED	10
CENTRAL CLOSING GATE CATCH	19	SELF LOCKING GATE CATCH - STRIKER-STRAIGHT	10
COWTIE HOOK	20	SELF LOCKING GATE CATCH (WITH STRIKER & C/W)	10
DEVON GATE DROPS	12	SELF LOCKING GATE CATCH ONLY	9
DOOR STAPLES	13	SINGLE LEG DRIVE CATCH	19
DOUBLE GATE FASTENER SET	22	SINGLE POST HOOK	5
DOUBLE POST HOOK	5	SLIP RAIL BRACKET SET	7
EXTENSION BASES	8	SLIP RAIL HALF ROUND HOLDER	8
EYE BOLT WITH "U" CLIPS	17	SLIP RAIL HOLDER	7
FENCING PANEL CLIPS	6	SLIP RAIL HOLDER	7
FERRULE LOCKING STRAINER	1	SLOTTED BAND FOR ADJ. FIELD GATE HINGE	18
FIELD GATE HINGE LONG BAND	18	SMALL RADISSEURS	1
FIELD GATE ADJUSTABLE EYE C/W BOLT 2 NUTS	17	SPRING CATCH	19
FIELD GATE BOTTOM HINGE	18	SPRING KEEP	19
FIELD GATE HINGE RISING S. BAND	20	SPRING LATCH	18
FLUTED ANGLE BRACKET	9	SPRING LATCH HINGE SET	22
GATE EYE TO WELD (FLAT)	16	SQUARE SECTION GATE STAPLE TO DRIVE	14
GATE HANGER TO BOLT	14	STANDARD FIELD GATE SET	21
GATE HOOK TO WELD (FLAT)	16	STANDARD HINGE SET HOOKS ON PLATE	22
GATE HOOK TO WELD (RADIUS)	16	STAPLE ON PLATE	3
GATE HOOK TO WELD (RADIUS)	16	STAPLE TO DRIVE	14
GRAVEL BOARD BRACKET	6	STRETCHER BARS	2
GRAVEL CLEAT	3	STRIKER DOUBLE LEG	10
GRAVITY CATCH FOR WOODEN POST	12	THROWOVER GATE LOOPS	11
HOOK FOR BRICK WORK	15	THROWOVER GATE LOOPS	11
HOOK ON NARROW PLATE	15	THROWOVER GATE LOOPS WITH LIFT HANDLE	11
HOOK ON PLATE	4	THROWOVER GATE LOOPS WITH LOCKING HASP STAPLE	12
HOOK ON SQUARE PLATE	15	TRELLIS CLIP	6
HOOK TO BOLT	14	UNWELDED EYE BOLT	5
HOOK TO DRIVE	15	VINE EYE TO DRIVE	9
HUNTING TYPE GATE CATCH	10	VINE EYE TO SCREW	9
KICK OVER GATE LATCH	13	WEATHER BAR	2
KICK OVER STABLE LATCH	13	WELDED EYE BOLTS	4

ITEM CODE	PAGE No.	ITEM CODE	PAGE No.
406	12	4568	8
412	9	5002	3
435	15	5002	3
452	4	6002	1
453	5	6252	13
454	5	8344	7
850	5	8344	7
851	5	8346	8
1000	11	9002	12
1164	6	9032	9
1247	9	9102	8
1418	2	9604	6
1502	2	19912	3
1800	10	75002	7
1803	15	1800CS	10
1805	10	1800DLS	10
1806	14	1800GC	9
1809	17	1800SS	10
1810	11	1809F	17
1810	11	1812AAS	18
1812	21	1812AL	18
1813	21	1812AS	18
1814	21	1814A	15
1816	11	1814AH	15
1817	22	1816LHS	12
1820	22	1820A	18
1820	14	1820B	19
1830	13	1820C	19
1845	1	1820D	19
1850	1	1820E	14
1856	1	1830A	13
1860	19	1865E	16
1870	12	1865H	16
1875	15	1866E	16
1880	4	1866H	16
1882	3	1890A	20
1884	4	473-474-475	6
1886	4	851A	8
1896	14	G0122	13
1897	7	G0710	20
1910	2		
1950	2		
2404	6		
2430	20		
2802	22		
4025	6		

